



## **MANYYEAR TECHNOLOGY**

Tension and Compression Load Cell Catalog

---



## MANYYEAR TECHNOLOGY

### Tension and Compression Load Cell Catalog

#### MLC306 hook scale force measuring machine force sensor 30ton

Model: MLC306

Category: S-type load cell

Range: 500kg, 750kg, 1000kg, 20ton, 30ton, 40ton

Size: Ø88\*44\*26mm, Ø 78\*185mm, Ø 105\*225mm

Material: Alloy steel, Stainless steel

Applications: Hook scales, crane safety overload, tension and compression tests, safety overload tests, tension tests

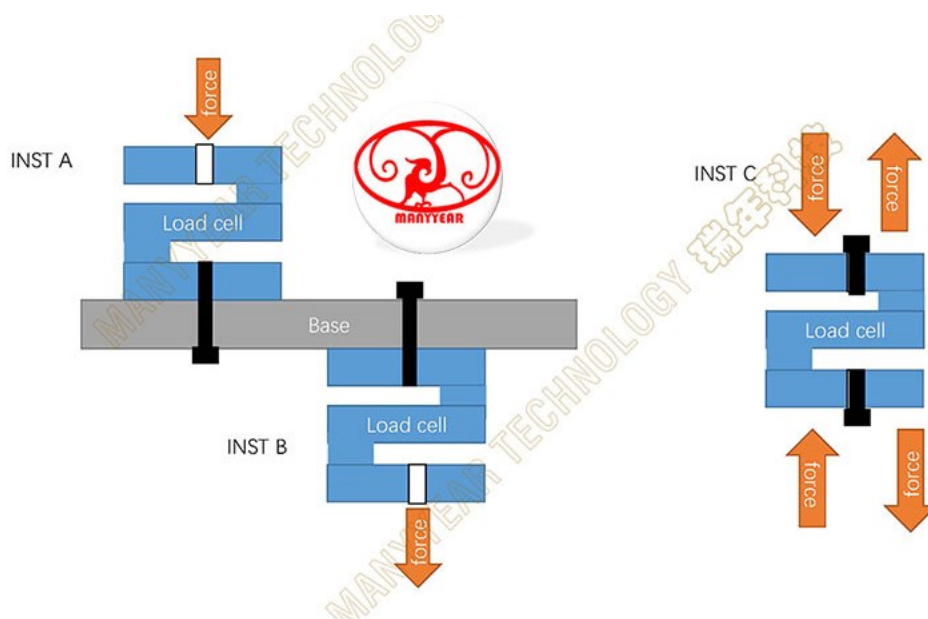



## MANYYEAR TECHNOLOGY

### Tension and Compression Load Cell Catalog

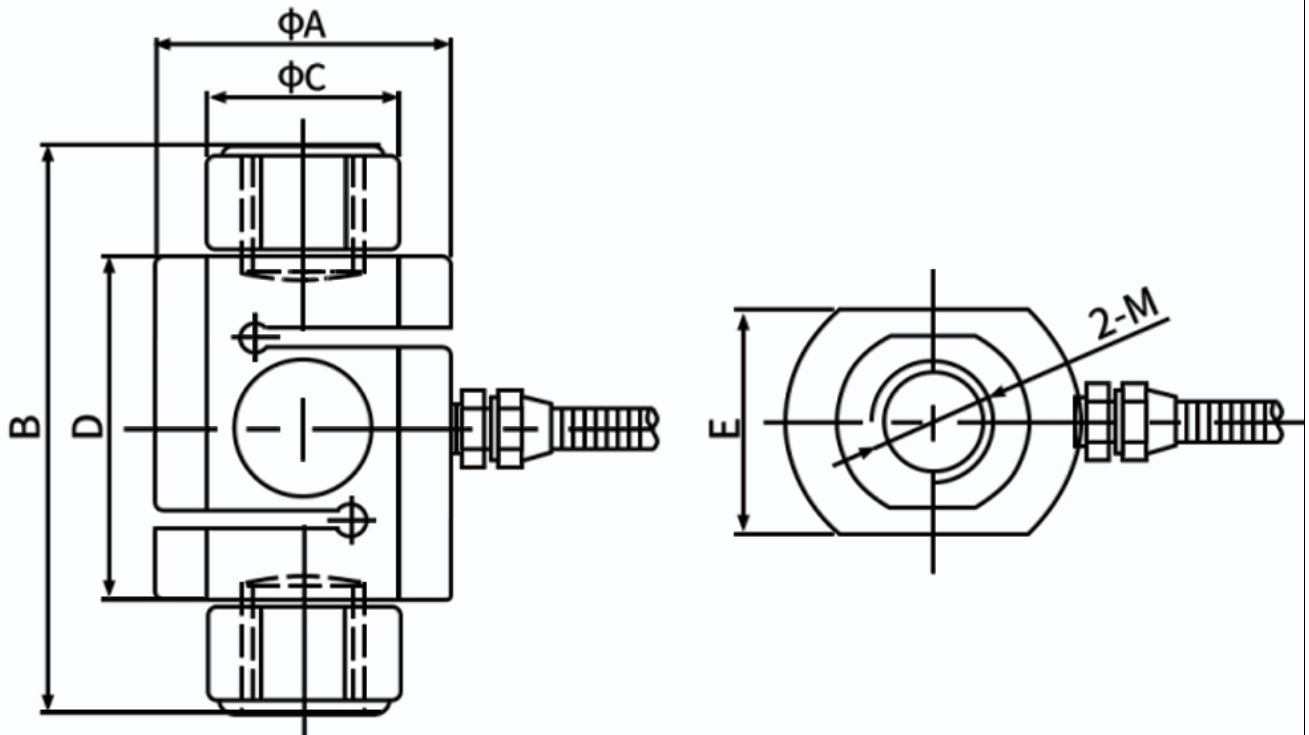

量程	ΦA	B	ΦC	D	E	M
0-1000kg	44	88	28	56	26	M16x1.5
1-5T	58	112	38	68	44	M24x3
10T	84	160	60	104	58	M36x4
20T	88	156	68.5	108	76	M36x4

Range	B	D	C	A	M*P
Technical specifications					
Comprehensive error:	0.03%FS		Output resistance:		350±5Ω
Rated output:	2±0.002mv/v		Insulation resistance:		≥5000MΩ(100VDC)
Nonlinearity:	0.03%FS		Operating Voltage:		9~12VDC
Lag:	0.03%FS		Compensation temperature:		-10~+40°C
Repeatability:	0.02%FS		Operating temperature:		-20~+65°C
Creep:	0.02%FS/10MIN		Effect of Temp. on zero point:		0.03%FS/10°C
Zero balance:	±1%FS		Effect of Temp. on sensitivity:		0.02%FS/10°C
Input resistance:	350±5Ω		Protection level:		IP66